

Wrapping Vertical Walls

Installation Guidelines for CommercialWrap

Installation Methods

To attach Tech Wrap to wood framed construction where the sheathing is plywood, insulated board, glass fiber faced exterior gypsum, or exterior gypsum board, use nails with large heads, nails with plastic washers, or staples with a minimum 1" crown.

To attach Tech Wrap to steel framed construction where the sheathing is glass fiber faced exterior gypsum, or exterior gypsum use screws with washers.

Step 1

Beginning at the corner of the building, leave approximately 6"-12" of Tech Wrap extended beyond the corner edge to overlap later. Hold the roll vertically and unroll for a short distance. Tech Wrap Commercial Wrap are lined up with the first stud. Also, make sure the roll is plumb and the bottom edge runs parallel to the foundation. Fasten Tech Wrap to the corner edge of the building.

Step 3

As best practice the bottom edge of Tech Wrap should always extend over the sill plate interface particularly when a sill sealer is not being used. Tech Wrap to the foundation with a polyurethane,

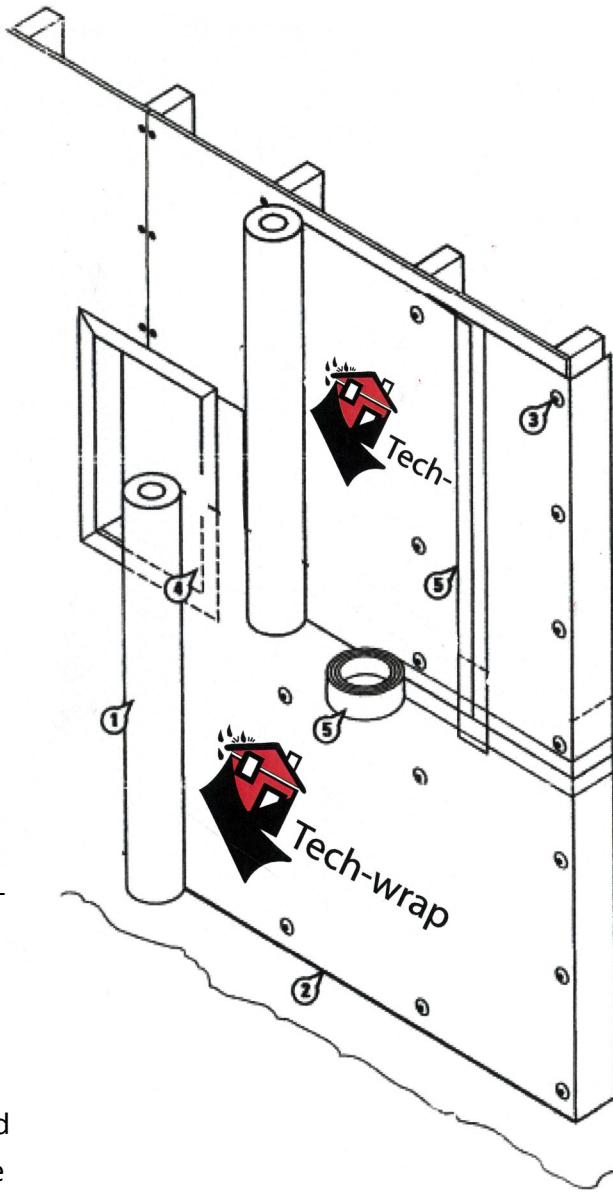

Step 4

Continue to unroll a few feet at a time, being careful to follow the foundation line. Secure Tech Wrap every 12"-18" on the vertical stud line when using plastic cap nails, largehead nails, screws with washers, or 1" crown staples. Ultimate-

Continued on top

Fastener holding power to the Tech Wrap weather resistive barrier depends on the sheathing chosen. If the sheathing's mechanical properties permit securely fasten Tech Wrap to it. If the sheathing mechanical properties do not permit reliable fastening of Tech Wrap ensure fasteners penetrate the framing members. Tech Wrap Workmanship in fastening Tech Wrap CommercialWrap is important. Optimum performance of Tech Wrap may not be achieved if fastener installation is done carelessly. Grid marks printed on CommercialWrap will make fastener placement easier.

Step 4

Unroll Tech Wrap directly over window and door openings. The Tech Wrap wrapped around the upper floors should overlap Tech Wrap around the lower floors by approximately 6" and be fastened where overlapped. Tech Wrap Contractor Tape should be used as a best practice to secure all horizontal and vertical seams.

Step 5

At the top plate, Tech Wrap should cover the interface of the upper and lower plates.